

SPECIFICATION DATA

AIR COMB SA-P AIR DIFFUSER

“AIRCOMB” diffusers shall be molded ABS Polymer equal to Cycolac E-4500 with ABS orifice nipple. The primary orifice shall be sized to meet project requirements. The secondary orifices shall be deeply serrated to provide even and continuous distribution of small bubbles. Each opening shall be tapered to provide an automatically adjustable orifice.

The diffuser shall be suitable design so as not to accumulate rags, trash, etc, and have a top designed to prevent accumulation of settle solids. The diffuser arrangement shall be shown on the plants and in conformance with the manufacturer's recommendations.



OXYGEN TRANSFER EFFICIENCY CURVE

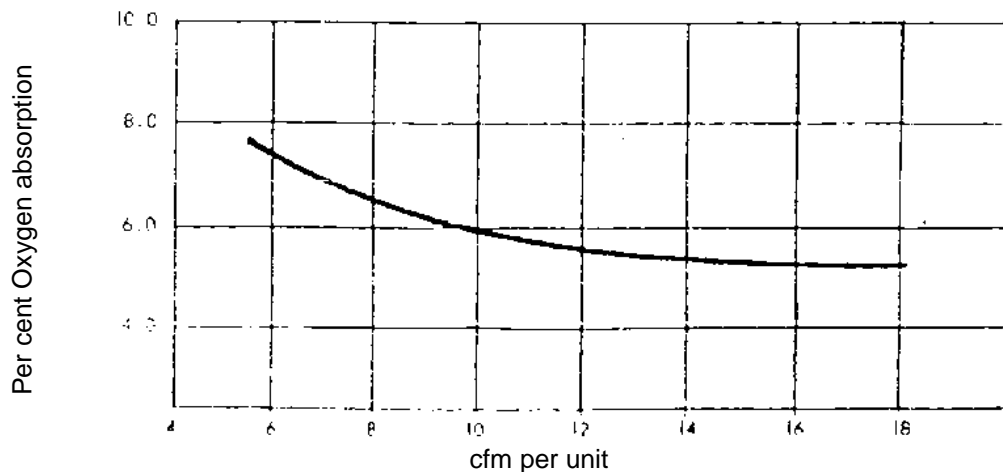

ARROW INDICATES
DIRECTION OF
PRIMARY ORIFICES

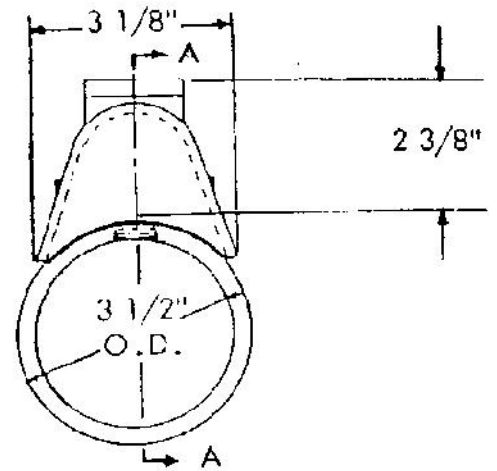
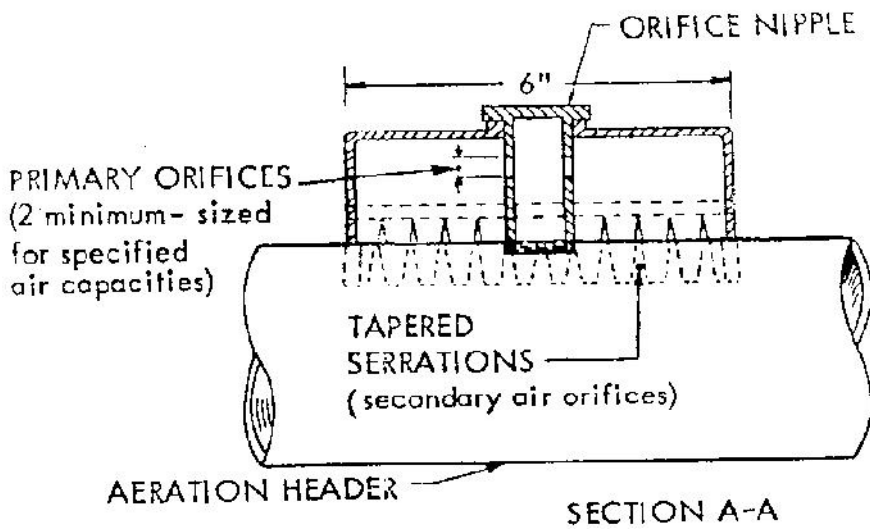
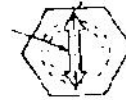

**HEAD LOSS CURVE SA-P AIR COMB
3/4" ABS NIPPLE WITH 2 ORIFICES**

